

RDY
2GO



Plot 431

Emerald

Four bedroom home at Attraction, Kingswood

SERIES

Nature

Inspired by the natural depth and character of wood, with warm, earthy tones and grain-like textures bring a grounded feeling. A balanced space to belong, live and grow.



1,421

Square foot home.

4 bedroom

Home over 2 floors.

£7,769

Worth of interior designed upgrades.
Including a turfed rear garden.



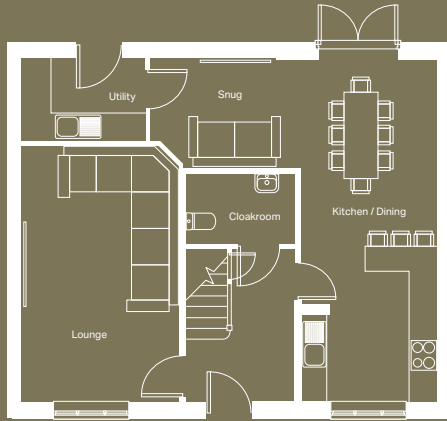

Ground floor

Kitchen / Dining (max)
2915mm x 7384mm

Snug (max)
3254mm x 2336mm

Lounge (max)
3327mm x 5519mm

Utility
2633mm x 1777mm

Cloakroom
2350mm x 1502mm

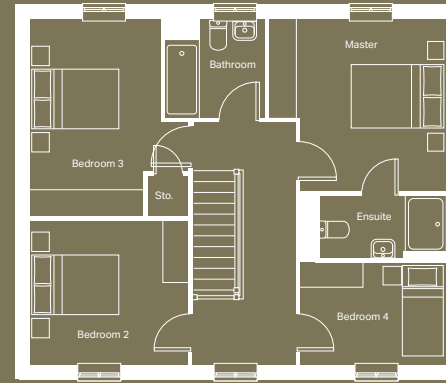

First floor

Master Bedroom (max)
3711mm x 3694mm

Ensuite
2699mm x 1350mm

Bedroom 2
3390mm x 3077mm

Bedroom 3 (min)
2800mm x 4218mm

Bedroom 4
3098mm x 2176mm

Bathroom
2141mm x 2102mm

Specification

FLOORING	Country Oak and Lincoln Twist 101
KITCHEN WORKTOP	Sonoma Oak
KITCHEN DOOR	Cashmere
HANDLES	HA9058
WC FLOOR AND WALL TILE	Bottega Caliza Wall and Nast Grey Floor
BATHROOM FLOOR AND WALL TILE	Dover Modern Line Acero Wall and Nast Grey Floor
EN-SUITE FLOOR AND WALL TILE	Bottega Caliza Wall and Nast Grey Floor
WARDROBE	Porcelain Matt
PLUMBING UPGRADE	Large Towel Warmer to Bathroom and En-suite, Shower Over Bath and Outside Tap
ELECTRICAL UPGRADE	15x White Spotlights, External Light and External Socket
OTHER UPGRADES	Turf to Rear







We're ready, are you?

Reserve now